



**PolyStax™**

Easily Transition

Heights with

**CMW PolyStax™**

# CMW PolyStax



CMW

## Create a Segmented Look at an Exceptional Price!

Stack one PolyStax or stack to the ceiling.

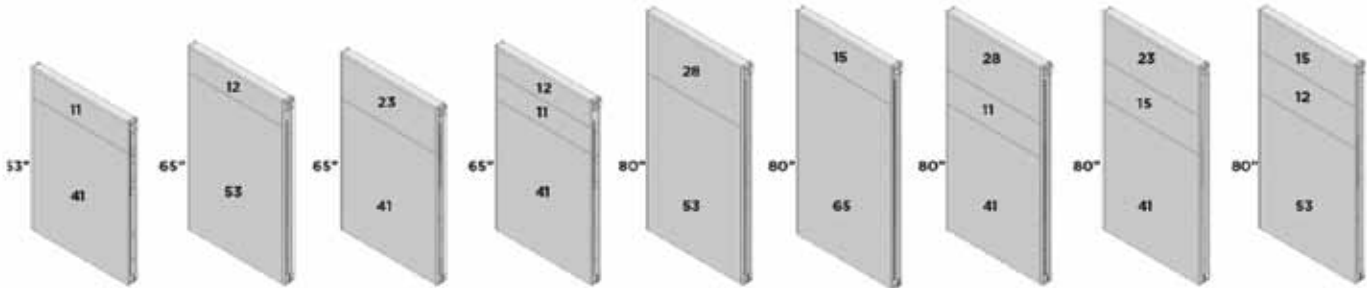

To maintain OEM standard heights - New panel height desired:

53" = 41" existing panel + 11" stacker  
 65" = 53" existing panel + 12" stacker  
 65" = 41" existing panel + 23" stacker  
 65" = 41" existing panel + 11" stacker + 12" stacker  
 80" = 53" existing panel + 28" stacker

80" = 65" existing panel + 15" stacker  
 80" = 41" existing panel + 11" stacker + 28" stacker  
 80" = 41" existing panel + 15" stacker + 23" stacker  
 80" = 53" existing panel + 12" stacker + 15" stacker

*Note: Any combination of PolyStax heights may be used per your design needs allowing for various alternative overall height options.*

*Full end cap is included on factory assembled panels*

## Remove | Replace | Interchange with the Unique Patent-Pending T-bone Bracket.

With four easy steps the CMW PolyStax unit is quickly and easily installed to existing panel(s).

- Step 1. Remove top cap and channel
- Step 2. Place the PolyStax joiner and stacker on the donor panel
- Step 3. Screw the PolyStax onto the donor panel and attach to any adjacent panels
- Step 4. Re-attach channel and top cap to the newly attached PolyStax unit

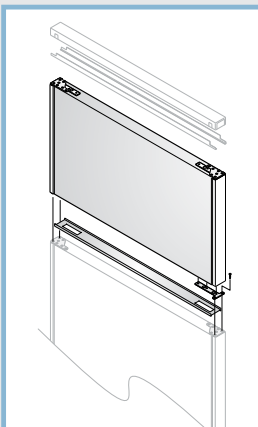

PolyStax stacker assembly

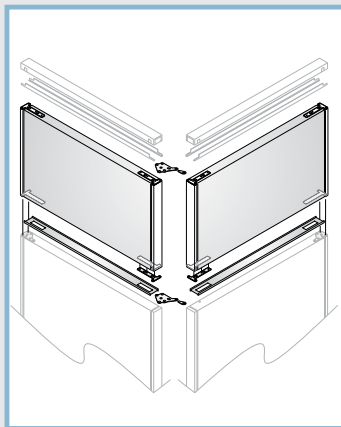

PolyStax "L" connection

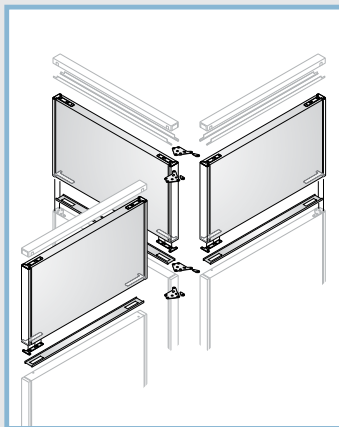

PolyStax "T" connection

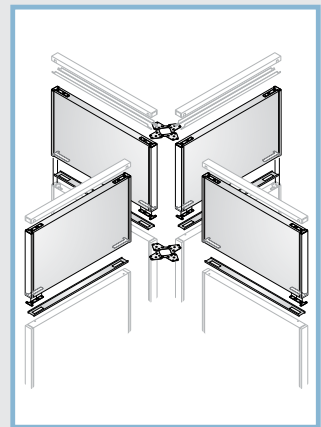

PolyStax "X" connection



## Build a New Look with Multiple Stacker Options

PolyStax units are available in eight different surface material options. Introduce different fabrics, marker board, acrylic windows (clear, smoked, frosted) and open pass-thru stackers to your office environment.

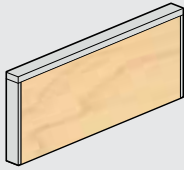

Laminate

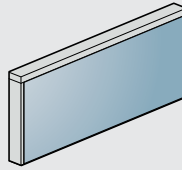

Fabric Covered Hard Surface

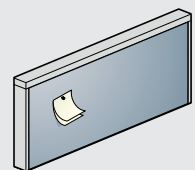

Fabric Covered Tackable or Acoustical

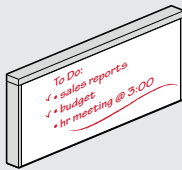

Marker Board

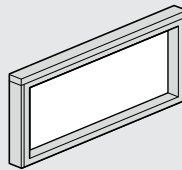

Open Pass-Through

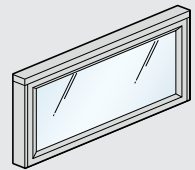

Glass (Clear/Smoked/Frosted)

## Floor-to-Ceiling Option

The CMW PolyStax can be stacked to the ceiling, giving you added flexibility.

- Creates a flush, aesthetically-pleasing and structural wall
- Easily connects to solid or grid ceilings at any height
- Ceiling track package has three simple parts: ceiling track, shrouds and end caps for quick installation
- Available in all standard CMW paint finishes including Solar Black, Gray Value 1, Tan Value 1, Warm Brown 1, Warm White, Woodrose, and 0835 Black
- Available in A02 finishes including Black Umber, Medium Tone, Light Tone, Light Gray
- Optional finishes are available, call Compatico Project Management to determine upcharges and lead times

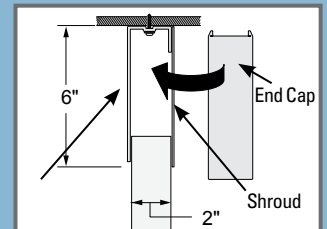
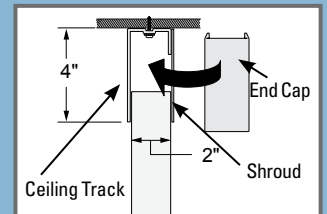

The CMW logo is displayed in white text on a green square background.

## PolyStax™ Benefits

Include PolyStax on your new system or add to an existing panel environment.

- The CMW PolyStax stacker is attractive, easy to install and provides more options for your ever changing office design needs.
- Create a segmented look for your office and stay within budget.
- Update your monolithic panels with the segmented look.
- Remove, replace, interchange depending on your needs.
- CMW PolyStax is mechanically fastened with Compatico's patent-pending technology saving hours on labor.
- Take your 2" CMW panels to the ceiling with the PolyStax C-Wall™ system.
- Hang flipper door units from the stacker units.
- Use our multiple finish options, acrylic clear, smoked, frosted, marker board, laminate, tackable hard surface fabric to build a new look around your office.

### Customer First Service Promise

Customer service is not just a department at Compatico. It is the core principle of our business philosophy. Our customers benefit through Compatico's total overall quality approach when an order is specified, priced, ordered and shipped. Our organization is designed to exceed customer needs. Our entire team is committed to timely delivery of quality products and 100 percent end-user satisfaction.

customerfirst  
service

**T.E. Berry & Associates**

PO Box 9606

Wichita, KS 67277-0606

316 942-4100

[info@teberry.com](mailto:info@teberry.com)



Member of  
Green Suppliers Network  
[www.greensuppliers.gov](http://www.greensuppliers.gov)