

SITMATIC®

Full Scale Seating



BOSS

SITMATIC®

BigBoss Task, 24" Wide



*Generous 24" wide,
XtremeDuty control with
heavy duty alloy tension
bar and adjustable height
and width armrests.*

391 XD +1N

BOSS



SITMATIC®

Boss Task, 21" Wide



*Roomy 21" wide,
SynchroLock control with
multi-select rocking ranges,
adjustable seat depth and
adjustable height, width
and angle armrests.*

381 SL SS +1A

BOSS



Ergonomically Engineered for Comfort

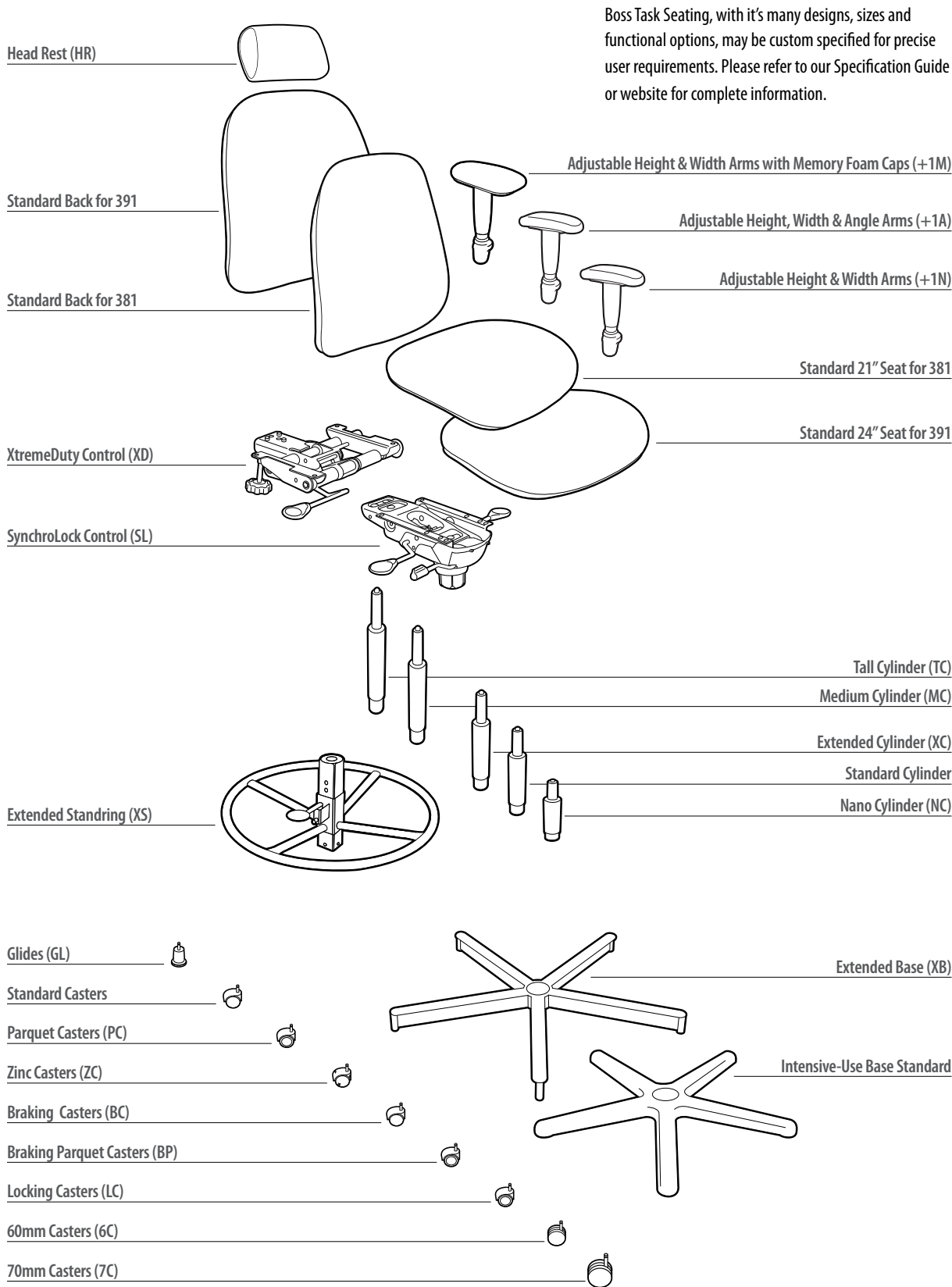

Boss Task Seating, with it's many designs, sizes and functional options, may be custom specified for precise user requirements. Please refer to our Specification Guide or website for complete information.

BOSS

Features

Chair Controls



SynchroLock Control (SL)
Synchronized, knee-tilt rocking motion with three selectable ranges, fully adjustable tension and can be locked in six different positions.



XtremeDuty Control (XD)
Designed for heavy-duty applications with synchronized rocking motion, fully adjustable tension and can be locked in the upright position.

Unique Boss Task Features



PressureCast™ Foam
Ergonomic contouring of the seat shape and high-resiliency PressureCast™ foam result in the most supportive and comfortable seat cushions possible. Each piece is individually cast to withstand the punishment of heavy-duty and plus-size usage. This foam is 50% thicker than standard. Seating comfort is determined by how well the weight of the user is distributed over the seating surface. Uneven distribution causes pressure points that quickly become painful. The result is constant fidgeting by the user to relieve the pressure and loss of circulation.



28" Between Armrests
Sized and proportioned for larger individuals and will support over 300 lbs. all day long.



Seamless, Intensive-Use Base
Safety is ensured with this specially engineered, five star base. Cast as a single piece, there are no welds to break.



Lumbar Support
The scientifically engineered shape hugs and supports the back from lumbar to thorax.



Green Check Certified
Boss chairs are independently tested to exceed Green Building Council's LEED-CI Indoor Environmental Quality Standards. IEQ 4.5 and may comply with MRS 5.0.



Massive Structure
Everything about the Boss Task Series is designed for tough use. The massive backrest upright is a cold-rolled alloy that will flex but will never break.



Easy Ratchet Back
A long 4" height range locks in 11 different positions- just lift the backrest to adjust.

BOSS

Desk and Conference Seating



High back chair with arms
389 XD (20") / 399 XD (23")



Mid back chair with arms
388 EZ (20") / 398 XD (23")

BOSS

Special Configurations



Mid back with EZ-Tilt control, hoop armrests and auto-return, non-height adjustable seat on jury base.

398 EZ JB

BOSS



Low back chair
383 EZ (20") / 393 EZ (23")



Guest chair
382 BB (20") / 392 BB (23")



24" wide chair, tall stool height, XtremeDuty control, extended, steel standring, extended, steel base and adjustable height and width armrests.

391 XD TC XS XB +1N

Exceptional Range of Seating Solutions



Management, Executive and Conference Seating



Task and Operational Seating



Occasional and Stacking Chairs



Auditorium and Public Seating

For further information on our comprehensive range of seating please visit our website or call our toll free number. Specifications are subject to change without notice.



**Green
Check
Certified**

T.E. Berry & Associates

PO Box 9606
Wichita, KS 67277
316 942-4100
tom@teberry.com

Sitmatic literature is printed on certified recycled paper and paper from well-managed forests and controlled sources.

Our products are certified compliant for LEED-CI indoor environmental air quality. Choosing Sitmatic chairs for your work place contributes to a cleaner, safer, more sustainable environment.